

REVISION DETAIL		
DESCRIPTION	DATE	APPROVED

OVERHEAD FIXING OPTIONS

**OVERHEAD BOLT FIXING
TWO TRACKS**

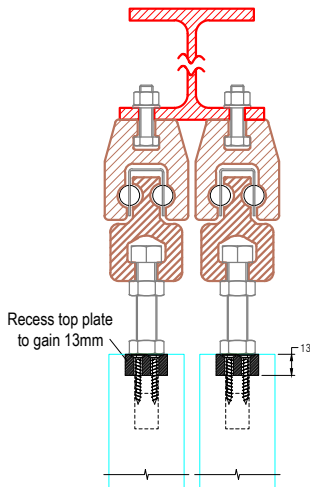

**OVERHEAD BOLT FIXING
TWO TRACKS**

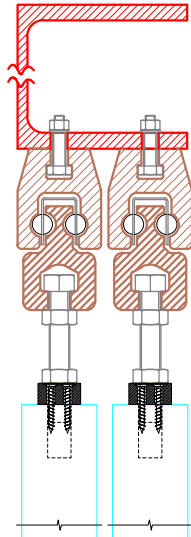

**OVERHEAD SCREW FIXING
TWO TRACKS
(TIMBER DOORS)**

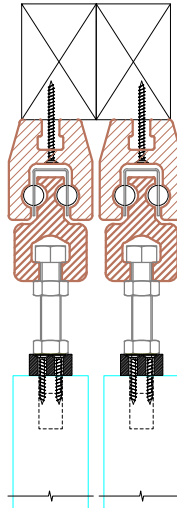

**OVERHEAD SCREW FIXING
TWO TRACKS
(ALUMINIUM DOORS)**

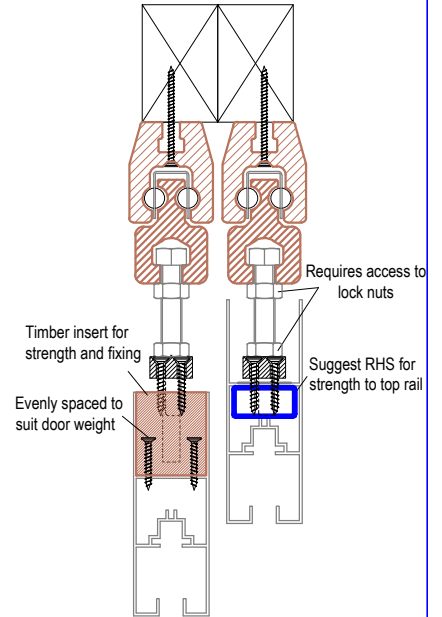

TIMBER DOOR GUIDE OPTIONS

**STAINLESS STEEL DOOR
CONNECTING GUIDES**

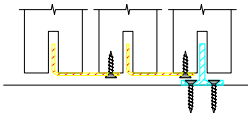

**NYLON RECESSED CHANNEL GUIDE WITH
STAINLESS STEEL DOOR CONNECTING GUIDES**

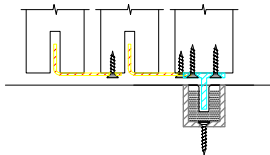

**BRASS TEE GUIDE WITH
NYLON RECESSED CHANNEL GUIDE**

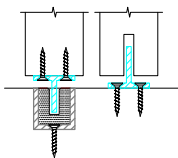

**NYLON RECESSED CHANNEL
GUIDE (NRC)**

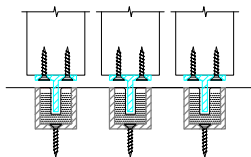

ALUMINUM DOOR GUIDE OPTIONS

**TWIN ROLLER GUIDES
COMPLETE WITH STAINLESS
STEEL CONNECTING GUIDE**

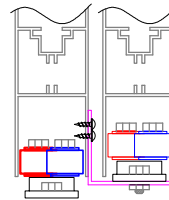

**BRASS TEE GUIDE
COMPLETE WITH STAINLESS
STEEL CONNECTING GUIDE**

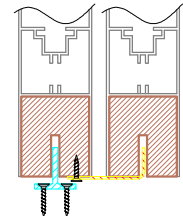

**NYLON RECESSED CHANNEL GUIDE (NRC)
WITH 2 BRASS TEE GUIDE PER DOOR**

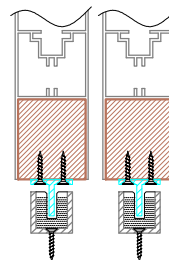

**NRC GUIDE COMPLETE WITH
STAINLESS STEEL
CONNECTING GUIDE**

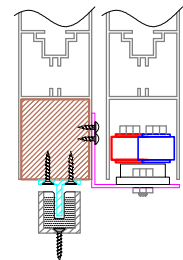

FITZROY.

BALL BEARING SLIDING TRACK SYSTEM

CHARLES MARSHALL PTY. LTD.

451 BURNLEY ST. RICHMOND. VIC. 3121 PH: 03 9429 9044 FAX: 03 9428 0238

3rd ANGLE PROJECTION

DO NOT SCALE

TITLE:

A500P ALLOY MEDIUM "FITZROY" PARALLEL SLIDING DOOR TRACK SYSTEM

DRAWN: B. Hunter

FINISH:

DATE: 1/03/2019

APPROVED:

PART. NO.

SHT
OF

THIS DRAWING AND DESIGN IS THE PROPERTY OF CHARLES MARSHALL PTY LTD AND MUST NOT BE COPIED, LOANED OR OTHERWISE WITHOUT THEIR EXPRESS PERMISSION OR LICENCE IN WRITING